



Kilkenny County Council
Comhairle Chontae Chill Chainnigh

Kilkenny

KILKENNY

CAPITAL PROGRAMME 2021-2023
Council Meeting 21st June 2021.



where medieval meets modern

Capital Programme

- Elected Members required to adopt a 3 year rolling programme each year.
- Funding must be available for each project.



Capital Programme

- Social Housing – 100% grant funding.
- Fire Stations – 100% grant funding.
- Roads – 100% grant funding.
- Roads – Partial grant funding.
- Other infrastructure – partial grant funding.
 - Balance of Funding from own sources.



Capital Spend 2016 - 2020

- Total expenditure over the 5 years from 2016 to 2020.
 - Total Expenditure - €243m
 - Total expenditure excl Housing - €99M.

		€'000's
Housing & Building		144,893
Roads		57,065
Water Services		3,437
Development		22,940
Environment		4,414
Recreation & Amenity		7,585
Miscellaneous		3,582
Overall Total		243,916
Total excl Housing		99,023





Kilkenny

MEDIEVAL MILE MUSEUM

Kilkenny

BUTLER GALLERY



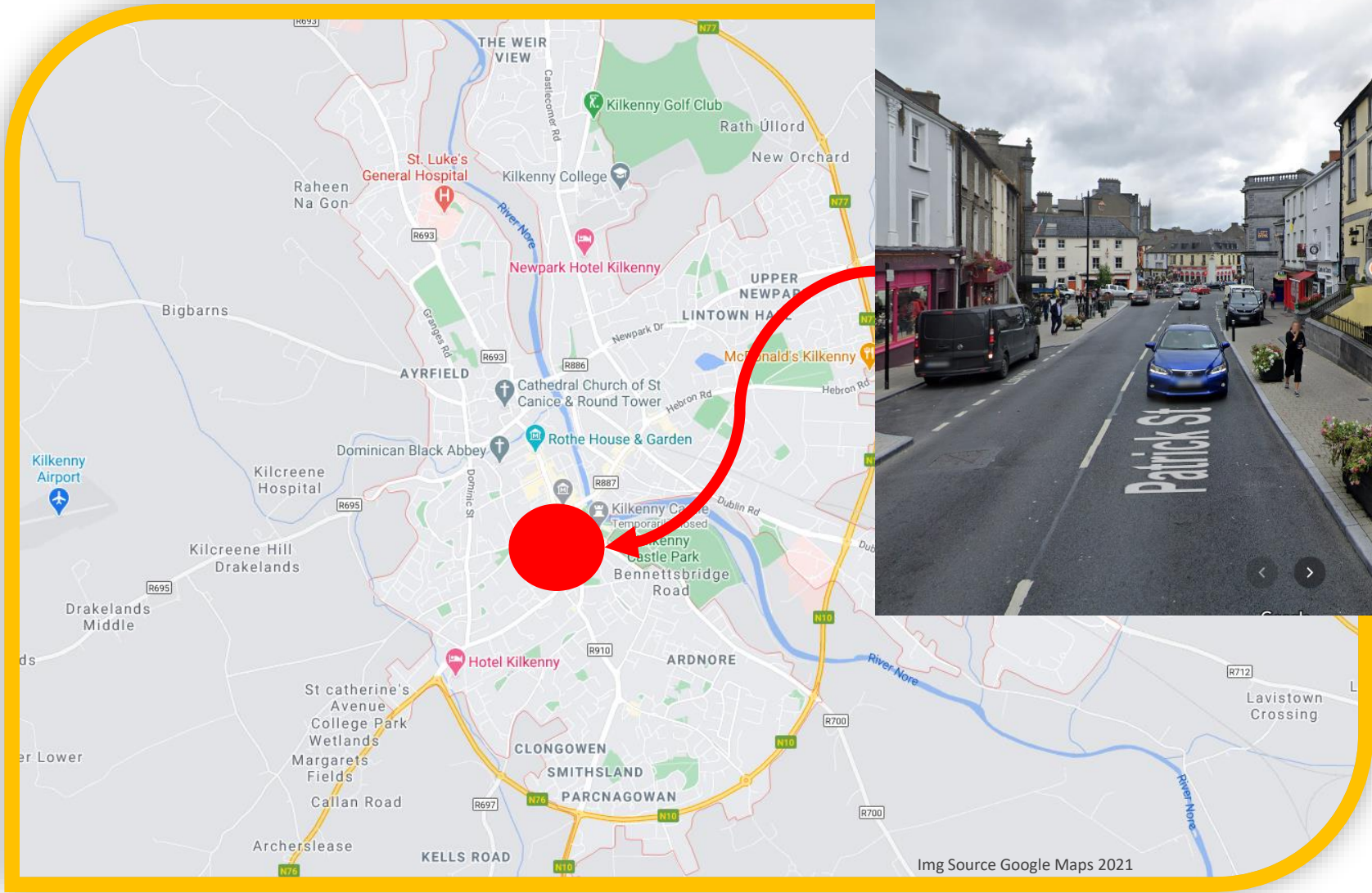

PATRICK STREET

Completed



BREAGAGH VALLEY

Kilkenny County Council providing the necessary infrastructure that will activate:

- Development of **870 new homes**
- A further **2,200 new homes** over the longer term; and
- Development of **2 new secondary schools**
- **OPP for Primary School**

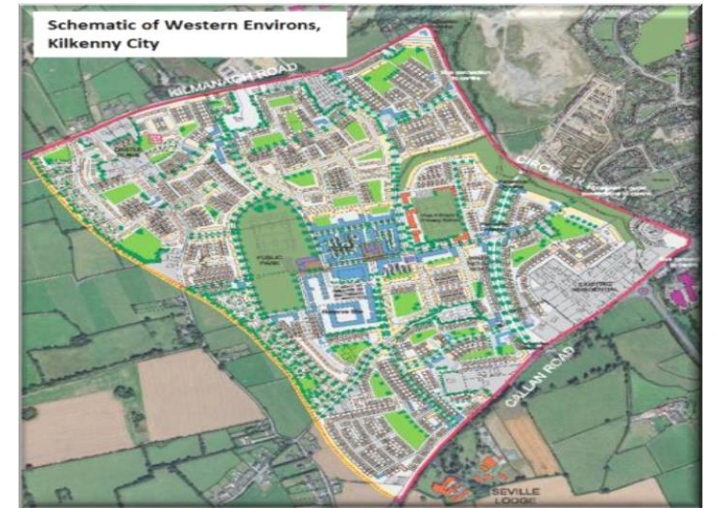

BREAGAGH VALLEY

A new residential neighbourhood, within a 10-minute walk of the City Centre.

It will be linked to the City Centre with walking and cycling paths.



Kilkenny

SKATE PARK & LINEAR PARK

- Opened on 09/06/21

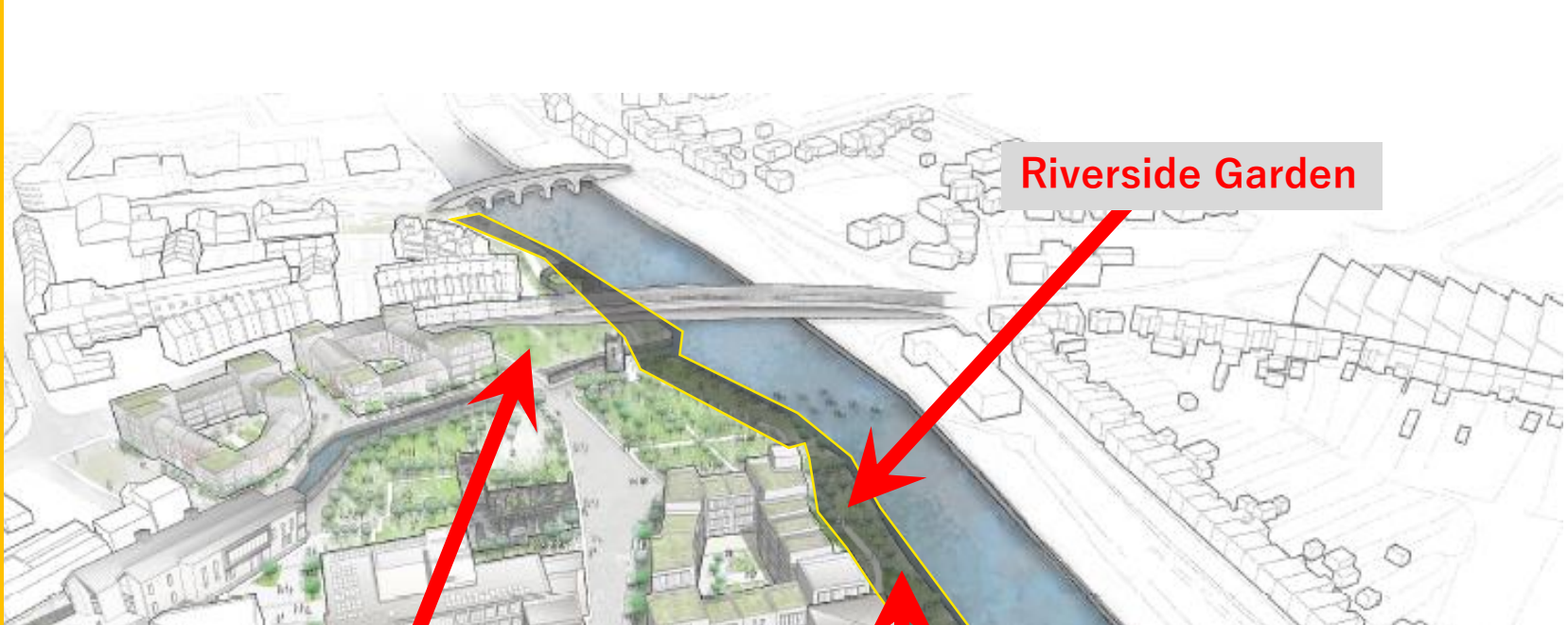

Riverside Garden



Capital Programme 2021-2023

- Social Housing
 - Estimated spend over period 2021-2023 - €150m
 - 100% grant funded.
 - Significant cashflow requirement to fund purchase / construction.
 - Affordable Housing.
- Fire Services
 - 100% grant funded.
 - Urlingford - Cost of €1.7m.
 - New Station for Kilkenny City - €6m approved.
 - Equipment – ongoing requirement.



Grant Funding Sources

- TII.
- DTTAS.
- OPW.
- LIHAF.
- URDF 2019 & 2020.
 - Abbey Quarter, Kilkenny City, Ferrybank.
- Libraries.
- ERDF.
- RRDF.
- ORIS.
- CLAR.
- Town & Village.
- Active Travel.
- Failte Ireland.
- Department of Arts.
- KIP



ROADS/FLOOD RELIEF— 100% Grant funded

Roads/Flood Relief	Funded by	Cost €m
N24 Waterford to Cahir	TII	680.00
N25 Glenmore to Waterford	TII	112.00
N24 Tower Road	TII	8.00
N24 Carrick road Mooncoin	TII	7.00
N77 Ballragget Village to Ballynaslee	TII	9.00
Castlecomer Pedestrian Bridge	TII	1.00
Graignamanagh Flood relief Scheme	OPW	9.00
Ballyhale Flood Relief Scheme	OPW	1.80
Total		827.80



CAPITAL PROGRAMME – LIHAF FUNDED PROJECTS

- **LIHAF - Western Environs:**
 - Final estimated cost of €15.3m.
 - Grant of €6.5m fully drawn down.
 - Match funding required of €8.8m.
 - Balance to be funded - €4.4m.
- **LIHAF - Ferrybank Park:**
 - Project complete.
 - Final cost - €854k.
 - Grant of €350k.



CAPITAL PROGRAMME – ABBEY QUARTER

- **Abbey Quarter:**
 - Site purchase + general spend = €7.4m.
 - €6.7m spent to date.
 - €1.7M Recharged to Abbey Quarter Partnership.
 - Balance to be funded of €380k.
 - **Phase 1: URDF 2019 Funded portion** – Riverside Park, Brewhouse Public Realm, Mayfair Public realm, Tea Houses, Cultural Hub, Temporary car Park.
 - Total estimated spend = €5.8m, match funding of €613k required.
 - €2.5m spent to date, Balance to be funded- €323k.
 - Riverside Park complete - €2.3m.
 - Horse barrack lane & Brewhouse courtyard to be completed with Brewhouse building - €2.3m.
 - **Phase 2: URDF 2020 Funded portion** – Urban Street, park, Greensbridge boardwalk, Tea Houses, Cultural project, maturation vats.
 - Estimated spend of €15.3m, match funding of €3.5m required.



St. Francis Park & Street

- Planning Permission granted in February 2021
- URDF Funding in place
- Detailed Design and Tender 2021
- Due to Commence on Site Q1 2022
- Due for completion Q2 2023
- Provides access and opens all plots for development





BOARD WALK PROJECT GREENS BRIDGE

- URDF Funding in place
- Design in 2021
- Planning Application 2022
- Works to commence 2022

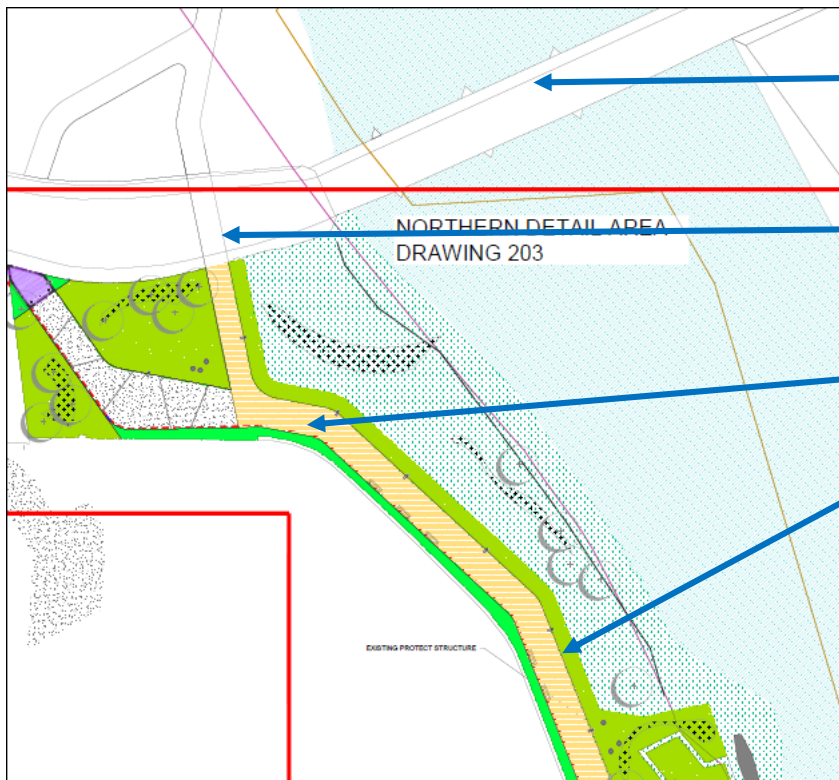

Greens Bridge

Existing Spare Arch

Proposed Riverside Gardens Connection

Riverside Gardens



CAPITAL PROGRAMME – URDF 2019

- **URDF 2019 – City Projects:**
 - Medieval Mile extension to Parliament Street.
 - Refurbishment of Vicar Street & Greensbridge St. – Greensbridge St complete.
 - Kilkenny - Off Street Connectivity.
 - Lighting up the Medieval Mile- commence in July 2021.
 - City Demarcation & Gateways.
- Total Estimated spend of €3.3m.
 - match funding of €825k required.
- MMM extension almost complete.



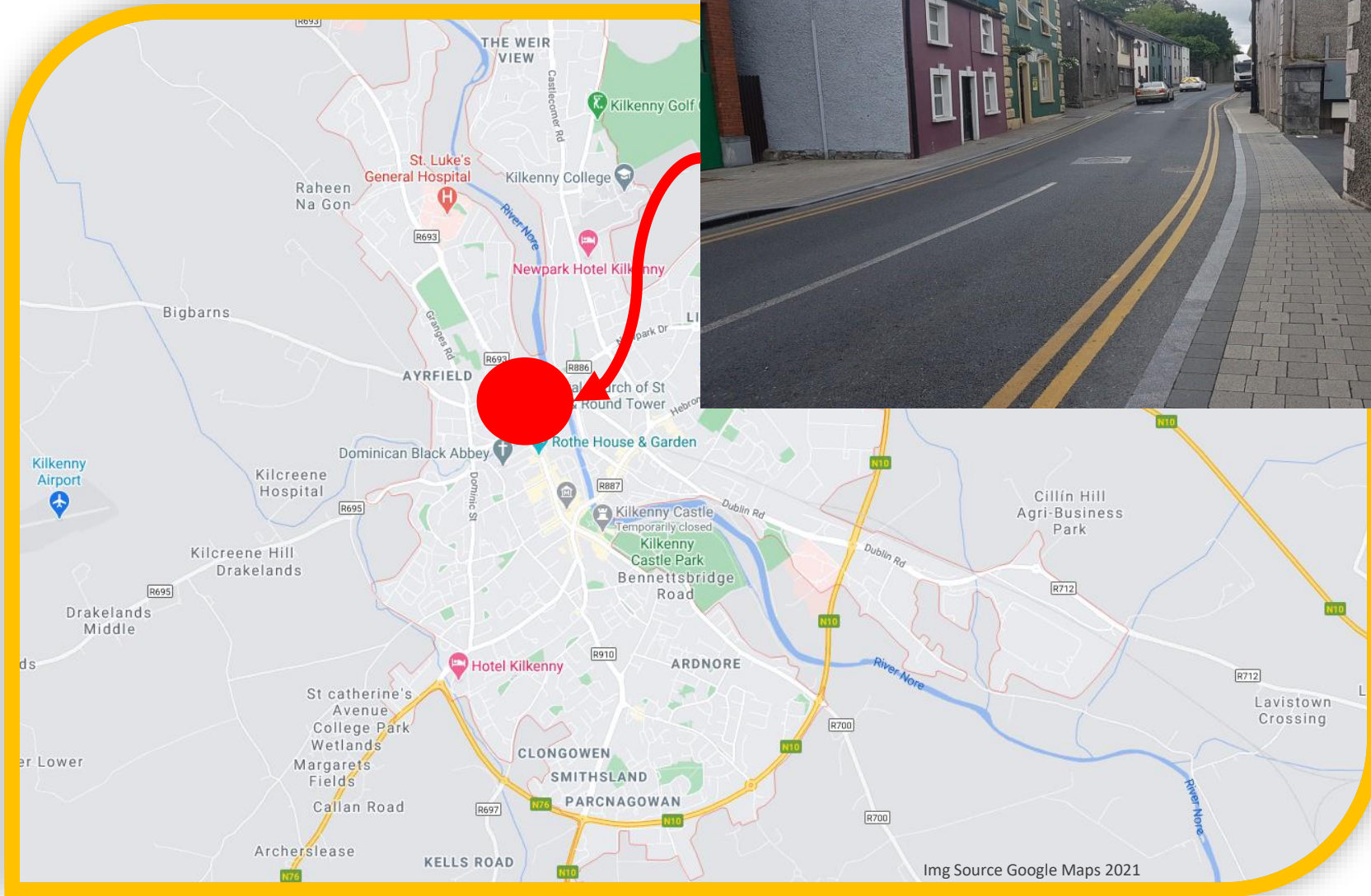

VICAR STREET

- Funding in place
- Works to commence Q1 2022





Kilkenny

LIGHTING UP MEDIEVAL MILE

- URDF Funding in Place
- Due for completion Q3 2021

CAPITAL PROGRAMME – URDF 2020

- **URDF 2020 – City Projects:**
 - Ormonde St upgrade – commence Sept 2021.
 - City Mobility Improvements(High St & Rose Inn St).
 - Kieran St Upgrade.
 - Carneige Plaza & Barrack Lane upgrade.
 - Upgrade St Mary's Precinct.
- Total Estimated spend of €8.8m.
 - match funding of €2.2m required.
- All projects at design stage.



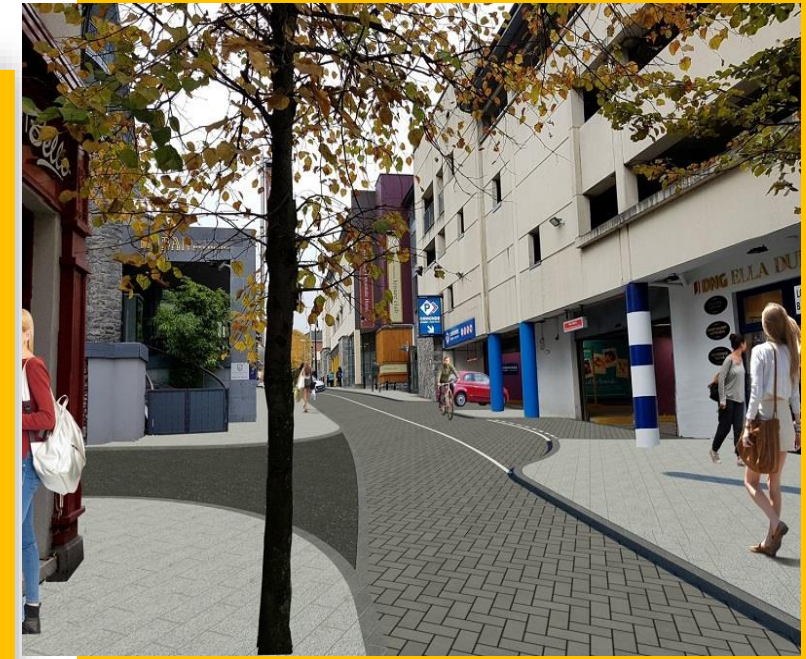
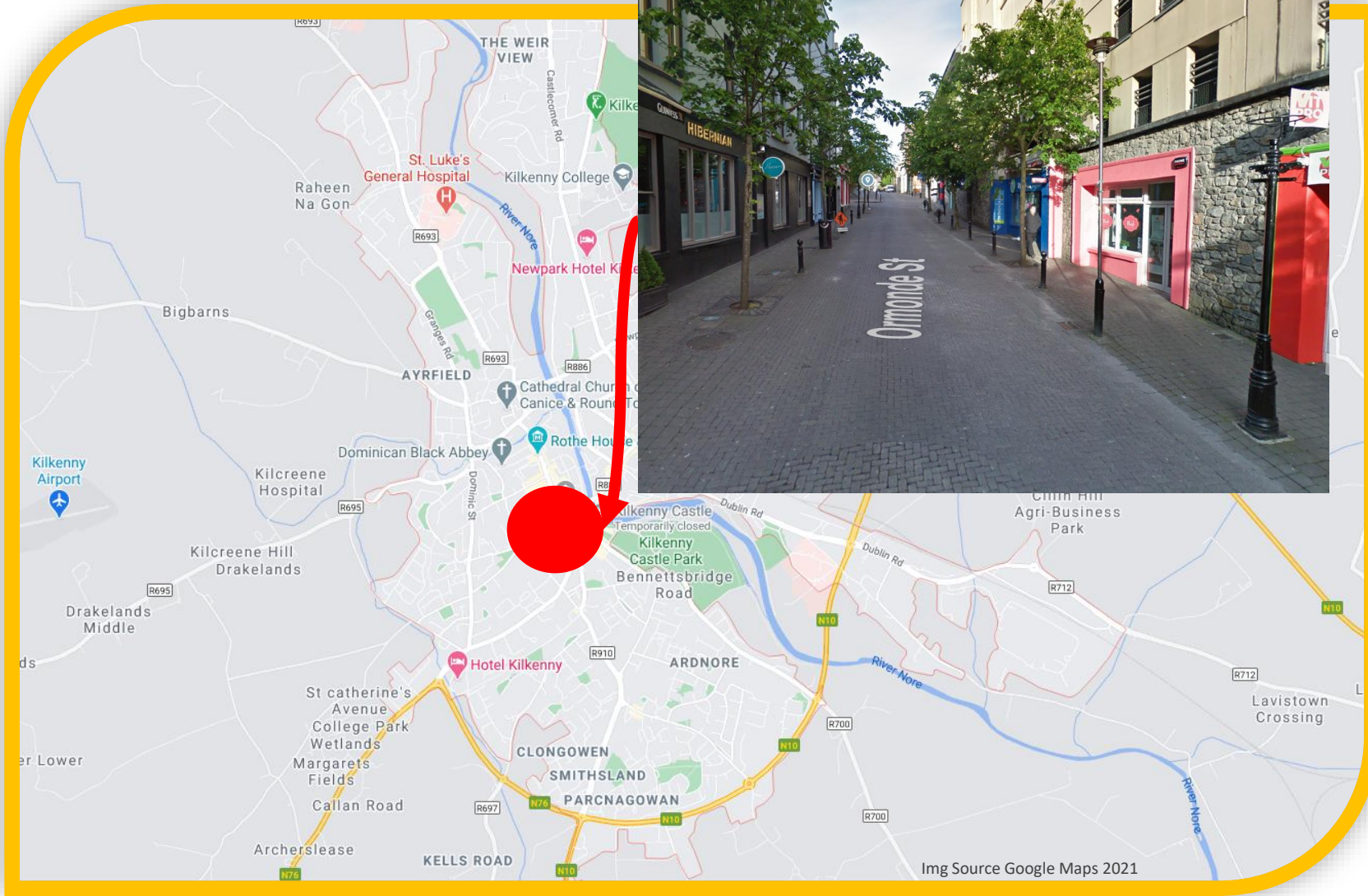

ORMONDE STREET

- Funding in place
- Works to commence Q2 2021



Kilkenny

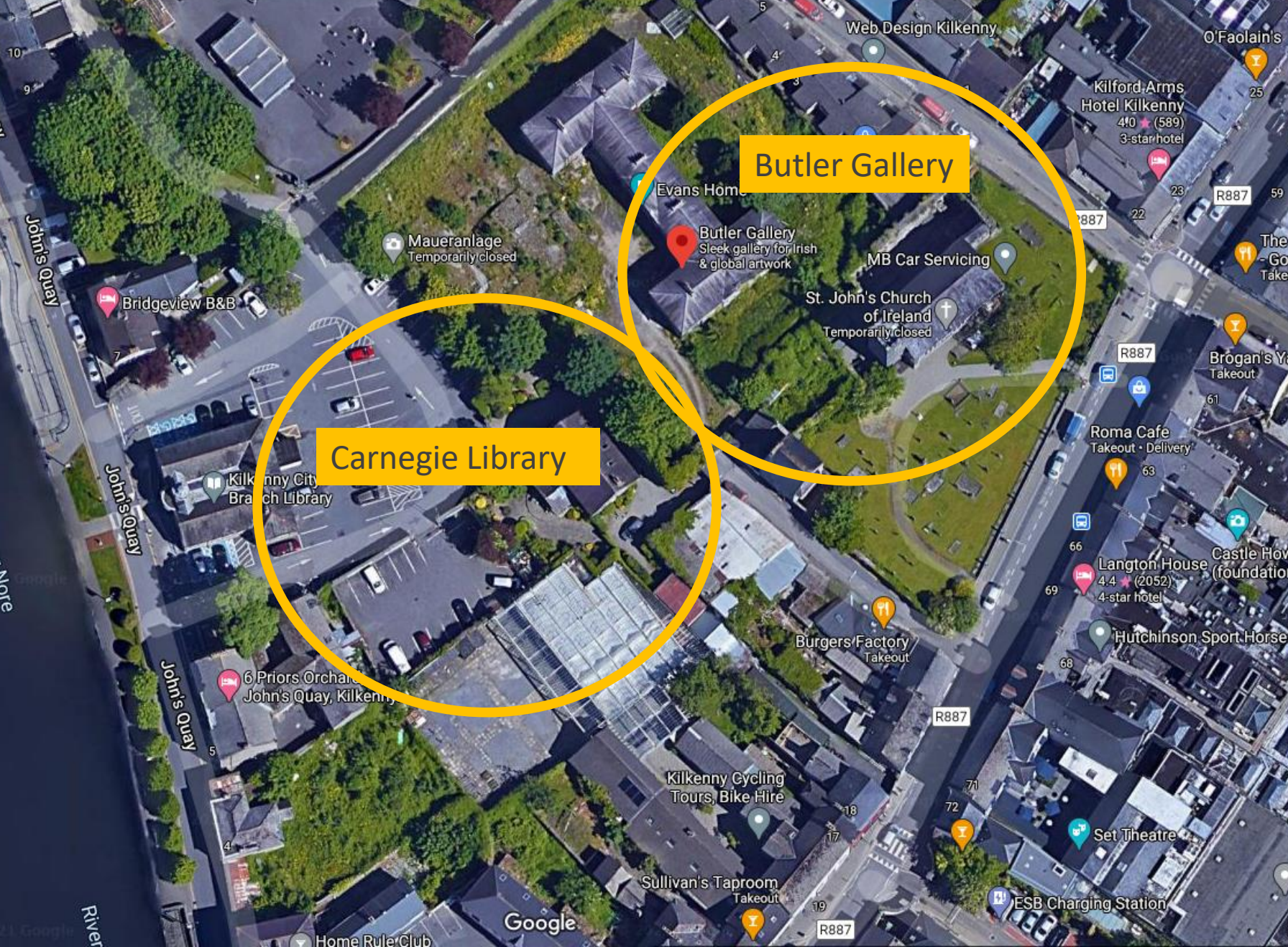

CARNEGIE Public Realm

- URDF Funding in place
- Detailed Design & Planning 2021 / 2022
- Works to commence 2022

CAPITAL PROGRAMME – URDF FERRYBANK

- **URDF 2019 – Ferrybank:**
 - Belmont Link Road.
 - Port Road.
 - Abbey Road - Greenway connectivity .
 - Abbey Road & Belmont Road.
- Total Estimated spend of €13.8m.
 - Match funding of €3.5m required.



CAPITAL PROGRAMME

- **City Library:**
 - Estimated cost of €6.4m.
 - €418k spent to date.
 - Match funding of €2.8m.
 - Additional grant funding applied for.
 - Tenders due in week beginning June 14th.
- **City Hall:**
 - Estimated cost of €5.2m.
 - Match funding of €1.8m.
- **Public Lighting:**
 - Estimated cost of €3.5m,
 - No grant funding available.



THE MAYFAIR

- The Mayfair will be converted into a modern public library
- Tender to issue – March 2021
- Construction to commence – July 2021

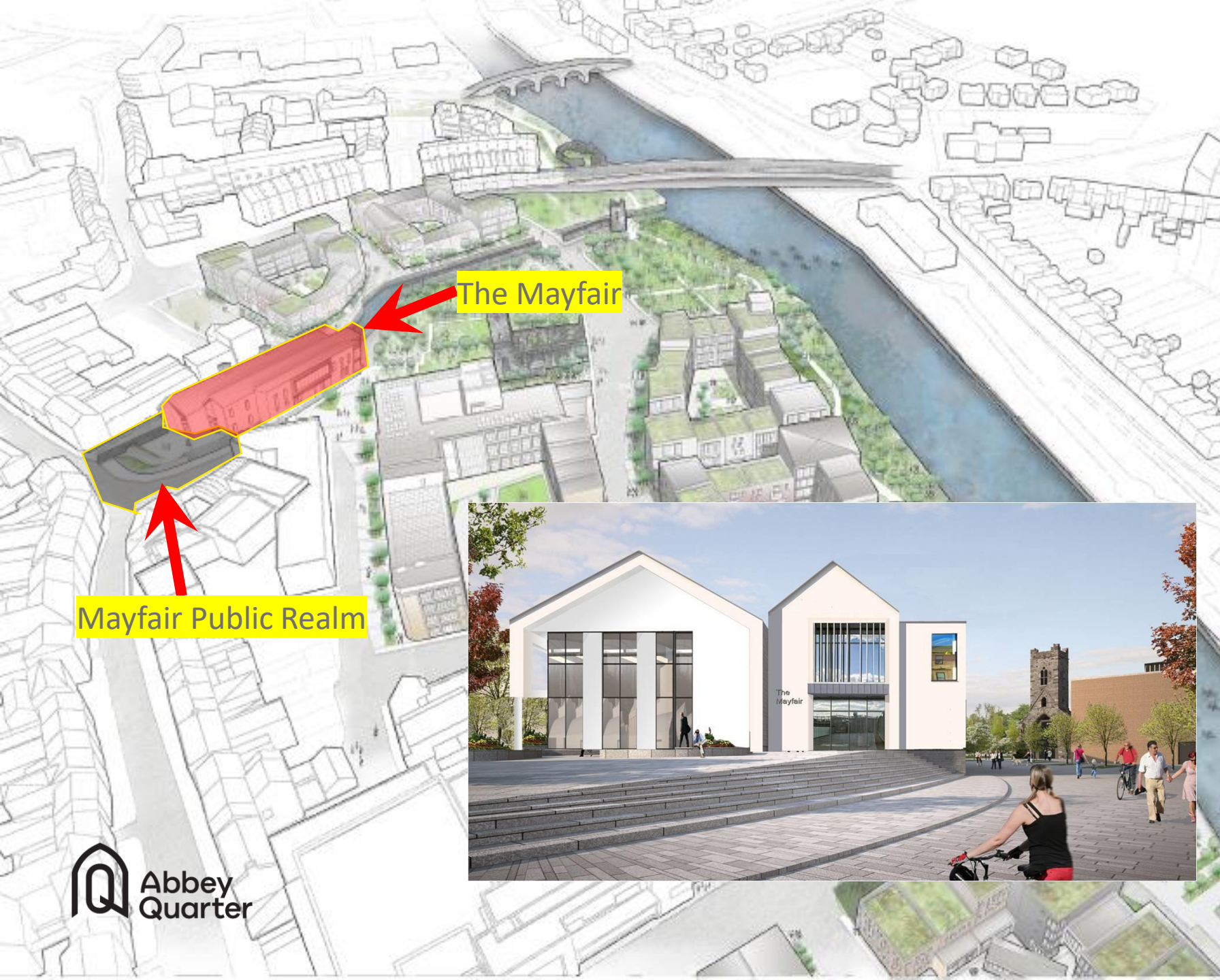



Kilkenny

MEDIEVAL EXPERIENCE KILKENNY

- Planning Permission in place
- Funding announcement from Failte Ireland imminent
- Detail Design 2021/2022
- Works due to commence 2022/2023



CAPITAL PROGRAMME

- **Greenway:**
 - Estimated cost of €15.7m.
 - 100% grant funding.
 - First construction contracts awarded.
- **Water sports Hub – City:**
 - Estimated Cost of €800k.
 - 100% grant funding.



Kilkenny

OUTDOOR RIVER HUB

- Proposed location County Hall / River Court
- Faillte Ireland funding under Platforms for Growth

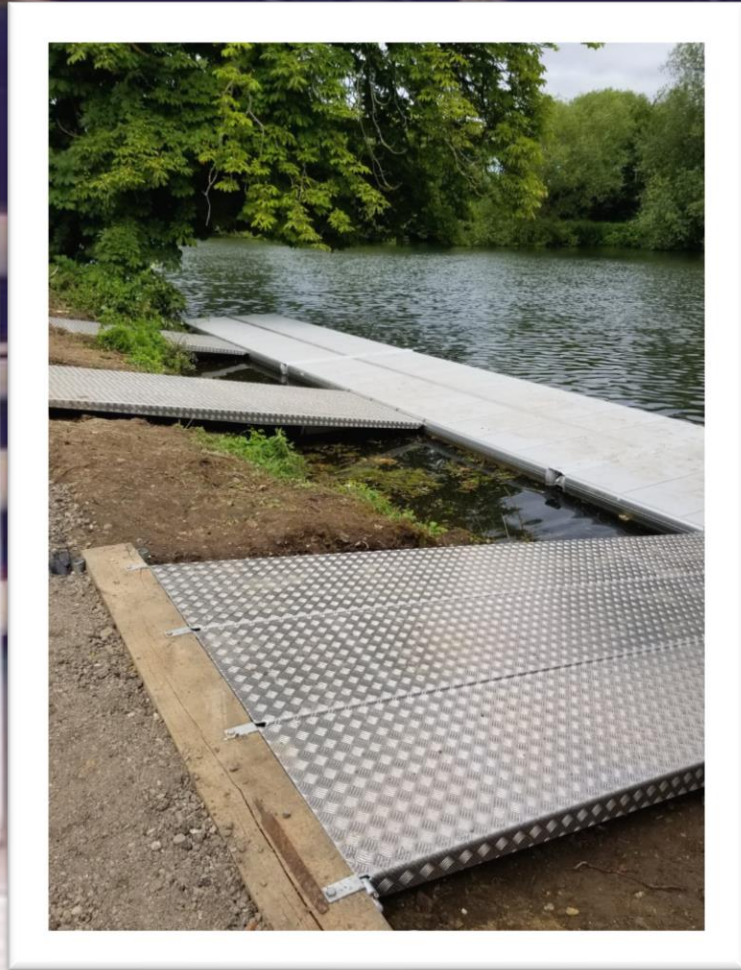

Example from Kilcullen Water Sports Club House

CAPITAL PROGRAMME - RRDF

- **RRDF Projects:**
 - Thomastown: -
 - Community centre & Library – Design Team appointed.
 - Quayside Car Park – Complete.
 - Sessions House – Commencing on site in June 2021.
 - Lowe/Logan Street – Near completion.
 - Estimated spend of €5.4m, match funding required of €1.1m.
 - Callan
 - Farigreen – Complete.
 - Motte Field – Complete.
 - Total spend €770k, Match funding of €100k.



CAPITAL PROGRAMME

- **City Other:**
 - Destination Towns.
 - Active Travel 2020 and 2021.
 - Total estimated spend of €4.33m.
 - Match funding of €260k required.
- **Loughmacask:**
 - Estimated spend - €3.7m.
 - Department of Education – funding €1.35m.
 - KCC match funding €2.4m.



Kilkenny



LOUGHMACASK

CAPITAL
PROGRAMME –
PROJECTS FUNDED
FROM CLAR, TOWN
& VILLAGE, ORIS,
KLP

- **ORIS**
 - Estimated spend of €2.0m.
 - Match funding of €400k.
 - 20 projects of which 8 are approved for funding.
- **CLAR**
 - Estimated spend of €900k.
 - 10% match funding.
 - 28 projects approved county wide since 2017.
- **Town & Village**
 - Estimated spend of €3.3m.
 - Match funding of €300k.
 - 46 projects approved countywide since 2017.
- **KLP**
 - Estimated spend of €1.4m.
 - Match funding of €250K.
 - 6 projects approved.



Other Projects

Northern Ring Road

Breagh Valley park and Link Rd

Watersports Hub

Shee Alms

Loughmacask

Graigenamanagh Library Roof

Subtotal

Total Expenditure	Total Income	Balance to be funded
€'000's	€'000's	€'000's
300	0	300
4,000	0	4,000
800	(800)	0
300	(150)	150
2,400	0	2,400
350	(100)	250
8,150	(1,050)	7,100

Other Projects

CAPITAL PROGRAMME.

- **No provision included for the following:**
 - Carneige building.
 - Callan Friary.
 - Woodstock.
 - Danville Link Road.
 - Watershed.
 - Watergate.
 - Castlecomer Discovery Park.
 - Rothe House



All Projects excl Housing/Fire/Roads (100%)		Total Expenditure	Total Income	Balance to be funded
		€'000's	€'000's	€'000's
LIHAF		16,154	(11,722)	4,431
AQ General		7,424	(7,045)	380
URDF 2019		9,069	(7,921)	1,148
URDF 2020 - App 1		15,341	(11,853)	3,488
URDF 2020 - App 2		8,854	(6,641)	2,214
URDF Ferrybank		13,826	(10,370)	3,457
Library		6,353	(3,511)	2,842
Tholsel		5,156	(3,397)	1,759
Public Lighting		3,571	(69)	3,502
Greenway		15,300	(15,300)	0
RRDF		6,402	(5,195)	1,206
City Other		3,972	(3,712)	260
ORIS		1,991	(1,612)	379
Clar		876	(883)	(7)
KLP Funded		1,435	(1,185)	250
Town & Village		3,332	(3,026)	306
Other - Unfunded		7,950	(850)	7,100
Total		127,005	(94,291)	32,714

CAPITAL EXPENDITURE 2021-2023 (EXCL. HOUSING, FIRE, ROADS(100%))

CAPITAL PROGRAMME 2021 - 2023

- Total estimated spend = €127m.
- Match funding required = €33M - €36m.
- Provision needs to be made for cost inflation.
 - Estimates only available at this stage for many of the bigger projects - Urban Street/Park, Ferrybank Projects, Breagh Valley Link.



- IPB Capital distribution €4.7m
- Asset Sales / Provisions €3.0m
- Development Contributions
 - Estimate of €2.3m per annum less €250k for CCFCS. €6.45m
- Term loan approved by Council not drawn down. €5.0m
- Term Loan approved for public lighting upgrade €3.5m
- Total funding available €22.65m.

Funding Available

DEVELOPMENT CONTRIBUTIONS

- Average annual cash receipts over the last 5 years - €2m.
- Assume average annual receipts of €2.3m over the next 3 years.

<u>2016</u>	<u>2017</u>	<u>2018</u>	<u>2019</u>	<u>2020</u>		<u>5 Years</u>
<u>€'000's</u>	<u>€'000's</u>	<u>€'000's</u>	<u>€'000's</u>	<u>€'000's</u>		<u>€'000's</u>
1,121	1,964	2,269	2,286	2,486		10,126
		Average over last 5 years ----->				2,025

BORROWINGS - KCC

- Term Loan of €13.5m drawn down in late 2016.
 - Annual cost of €800k.
- Term loan of €5m drawn down in 2020.
 - Repayments of €300k provided for in the 2021 Budget.
- Term loan of €5m approved by Members at December 2019 meeting.
 - Not drawn down yet.
 - Repayments provided for in the 2021 Budget
- Total non mortgage debt drawn at the end of 2020 = €18.5m.
- Outstanding Commitments on completed capital projects
 - €9.0m.
 - Annual cost of €1.5m.



CAPITAL PROGRAMME

- 3 year capital programme to be finalized and approved by Council subject to securing funding for individual projects.
- Funding shortfall to be addressed.
- Council must have identifiable funding source for each project.
- Current estimate of funding shortfall = €15m minimum.
- Opportunities for additional grant funding to be explored.





Kilkenny County Council
Comhairle Chontae Chill Chainnigh

Kilkenny

KILKENNY

CAPITAL PROGRAMME 2021-2023



where medieval meets modern