



Date: 4th September, 2023

Our ref: D28/694/F

**TO: THE CATHAOIRLEACH
AND EACH MEMBER OF KILKENNY COUNTY COUNCIL**

**RE: DISPOSAL OF INTEREST IN LAND AT BALLYLUSKY, MULLINAVAT,
CO. KILKENNY**

A Chara,

Notice is hereby given, that at a meeting of the Council to be held after the expiration of 10 days from the date of this notice, it is the intention of Kilkenny County Council, in accordance with Section 183 of the Local Government Act, 2001, to dispose of its interest in land at Ballylusky, Mullinavat, Co. Kilkenny - as identified on the attached map - to Richard Raftice, Ballylusky, Mullinavat, Co. Kilkenny for the sum of €1,500 and the Purchaser will be responsible for all legal costs associated with the sale. Plot areas combined measure 1.75 acre. The Consent of the Minister for Housing, Local Government and Heritage is not required. [Note: The Land Development Agency Act, 2021 requires that the disposal of any relevant public land by a Local Authority be firstly offered to the Land Development Agency for its consideration].

BACKGROUND

This land was acquired for the M9 Motorway Scheme. Plot 163 was for in stream works on a watercourse but in the end was not required. Plots 165 and 166 are generally the Access Track which is solely used by Mr. Raftice. There is some attached agricultural land for which Mr. Raftice will pay €1,500 and he will also be responsible for Kilkenny County Council's legal fees. In addition, Mr. Raftice will transfer two small Plots of M9 land to Kilkenny County Council. These plots are identified as Plot 166-A and 166-B on the attached map.

Mise, le meas,

Martin Prendiville

Martin Prendiville
Head of Finance

Location Plan

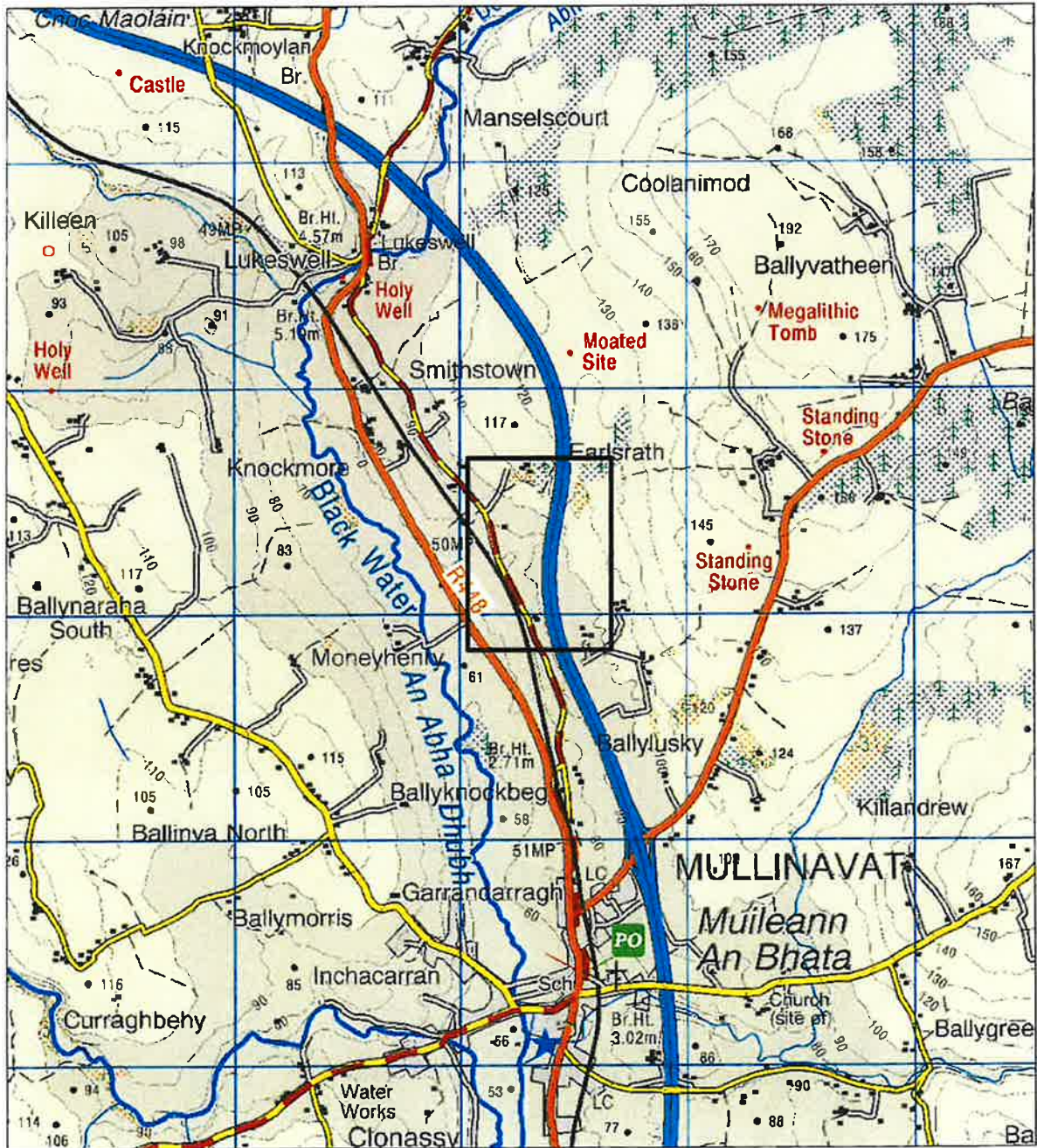

Land at Ballylusky, Mullinavat,
Co Kilkenny

E656729.182
N626801.599

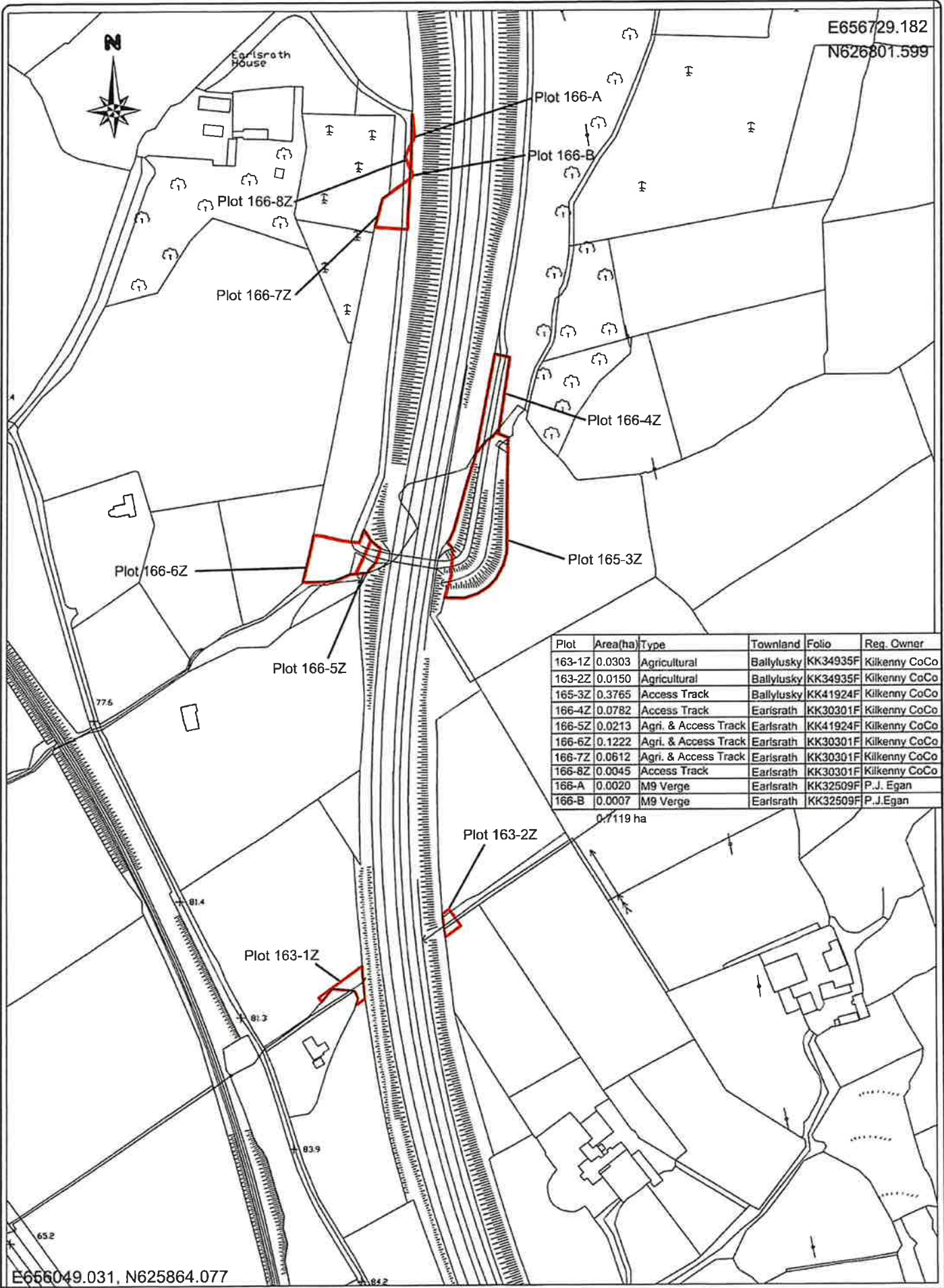

Plot	Area(ha)	Type	Townland	Folio	Reg. Owner
163-1Z	0.0303	Agricultural	Ballylusk	KK34935F	Kilkenny CoCo
163-2Z	0.0150	Agricultural	Ballylusk	KK34935F	Kilkenny CoCo
165-3Z	0.3765	Access Track	Ballylusk	KK41924F	Kilkenny CoCo
166-4Z	0.0782	Access Track	Earlsrath	KK30301F	Kilkenny CoCo
166-5Z	0.0213	Agri. & Access Track	Earlsrath	KK41924F	Kilkenny CoCo
166-6Z	0.1222	Agri. & Access Track	Earlsrath	KK30301F	Kilkenny CoCo
166-7Z	0.0612	Agri. & Access Track	Earlsrath	KK30301F	Kilkenny CoCo
166-8Z	0.0045	Access Track	Earlsrath	KK30301F	Kilkenny CoCo
166-A	0.0020	M9 Verge	Earlsrath	KK32509F	P.J. Egan
166-B	0.0007	M9 Verge	Earlsrath	KK32509F	P.J. Egan

E656049.031, N625864.077



Rev	By	Date	Description

Ordnance Survey Licence Number
2023/27/CCMA/Kilkenny County Council

Project:	M9 Motorway
Component:	
Title:	Land Ballylusk & Earlsrath
Drawn By:	AM
Checked By:	AM
Scale:	1:2500 (at A3)
Date:	May 2023
Drawing No.	M9-CPO/163-1A